

Submersible sludge pump 80 - GFHU - MH spare parts					
Position	Name	No. of stock item	No. of drawing	pc	
102	VOLUTE "MH"		20-SV-9-7007	1	
107	DISCHARGE ELBOW		20-SV-715281	1	
160	TERMINAL BOARD COVER		20-SV-805968	1	
180	OIL PAN BOTTOM		20-SV-804959	1	
230	IMPELLER		20-SV-7084	1	
272	FIRE POLYAMIDE FIBRE HOSE JS 75BG	20-665 134075 0010		1	
274	STRP 9X 600	20-548 241 557 8000		1	
275	CLIP 9	20-548 241 557 8000		2	
321	BEARING UR 6303C3	20-324 163 030 086 0		1	
323	BEARING UR 3208C3	20-324 232 080 003 0		1	
350	LOWER BEARING HOUSING		20-SV-9748	1	
352	UPPER BEARING HOUSING		20-SV-805 959	1	
360	BEARING COVER		20-SV-533957	1	
400.1	WEAR RING 18X24	20-278 413 104 017 0		1	
400.2	WEAR RING 12X18X2	20-722 819 018 212 0		1	
400.3	DISCHARGE ELBOW PACKING		20-SV-517148	1	
411	RING SX9	20-722 811 005 009 0		2	
412.1	RING 190 X 5	20-273 111 014 704 0		1	
412.2	RING 240 X 3	20-273 111 014 774 0		2	
412	RING 160 X 3	20-273 111 014 634 0		1	
433	MECHANICAL SEAL 2Z-SP-KK-28-80	UP 229		1	
463	COVER SHEET	20-426 910 122 880 0		1	
502.1	IMPELLER SEAL RING		20-SV-518845	1	
502.2	VOLUTE JOINT RING		20-SV-518844	1	
550	WASHER 8	CSN 02 1740.0	20-311 131 400 082 0	24	
550.1	WASHER 6	CSN 02 1740	20-311 131 400 061 9	2	
554	WASHER 5,3	CSN 02 1702.1	20-311 132 010 053 9	11	
554.1	WASHER 8,4	CSN 02 1740.1	20-311 132 010 084 0	25	
554.2	WASHER 6,4	CSN 02 1702.1	20-311 132 010 064 9	2	
576	HANDLE		20-4V-726 538	1	
811	STATOR BODY		20-SV-904045	1	
813	ELECTRIC MOTOR 4TMV 132S-2	EMBRNO	20-359 432 511 701 8	1	
818	ROTOR 4 TMV 132S-4		20-359 432 511 701 2	20-4V-735 972	1
824	CABLE HO7RN-F 6G1,5		20-341 999 999 004 0	1	
826	BUSHING CLIP		20-SV-527 389	1	
826.1	BUSHING RUBBER LINER	20-273 111 583 364 0		1	
826.2	BUSHING LINER	20-273 111 583 956 0		1	
826.3	WASHER		20-SV-584 306	2	
834	BUSHING		20-SV-720 539	1	
835	TERMINAL BOARD		20-SV-520 311	1	
839	EARTHING TERMINAL		20-SV-517 142	2	
897	FLANGE		20-SV-714614	1	
900	BOLT M6 X 25	DIN 939/A2	20-311 112 090 625 0	2	
900.1	BOLT M8 X 25		20-991 511 165 5300	8	
900.2	BOLT M8 X 20	CSN 02 1178.2	20-991 511 167 2500	3	
900.3	BOLT M8 X 30		20-991 511 087 1300	2	
900.4	HANDLE SCREW		20-991 511 168 9200	2	
900.5	BOLT M5X16	CSN 02 1226.0	20-311 112 260 5160	3	
901	BOLT M6 X 12	CSN 02 1103.2	20-311 112 030 612 9	1	
901.1	BOLT M8 X 30		20-991 511 165 5400	8	
902.1	BOLT M8 X 20	CSN 02 1176.2	20-311 112 780 820 9	3	
902.3	BOLT M8 X 25	CSN 02 1178.2	20-311 112 780 825 0	2	
902.9	BOLT M 16 X 50	CSN 02 1176	20-311 112 761 650 9	4	
902.10	BOLT M 10 X 35	CSN 02 1176	20-311 112 761 095 9	4	
904	BOLT M6 X 16	CSN 02 1151.9	20-311 112 590 616 0	2	
914	CHECK SCREW		20-SV-116529	1	
916	PLUG M16X1,5	DIN 910	20-991 503 161 5000	1	
922	NUT M8	DIN 934/A2	20-311 122 010 800 9	4	
922.1	NUT M8	CSN 02 1401	20-311 122 010 800 9	5	
922.2	IMPELLER NUT		20-SV-109685	2	
932	WASHER 6,4	CSN 02 1702.1	20-311 132 010 064 9	2	
932.1	RETAINING RING 40		20-311 733 000 400 0	1	
932.2	RETAINING RING 17		20-311 733 000 170 0	1	
940	KEY BK7x25		20-311 172 208 725 0	1	

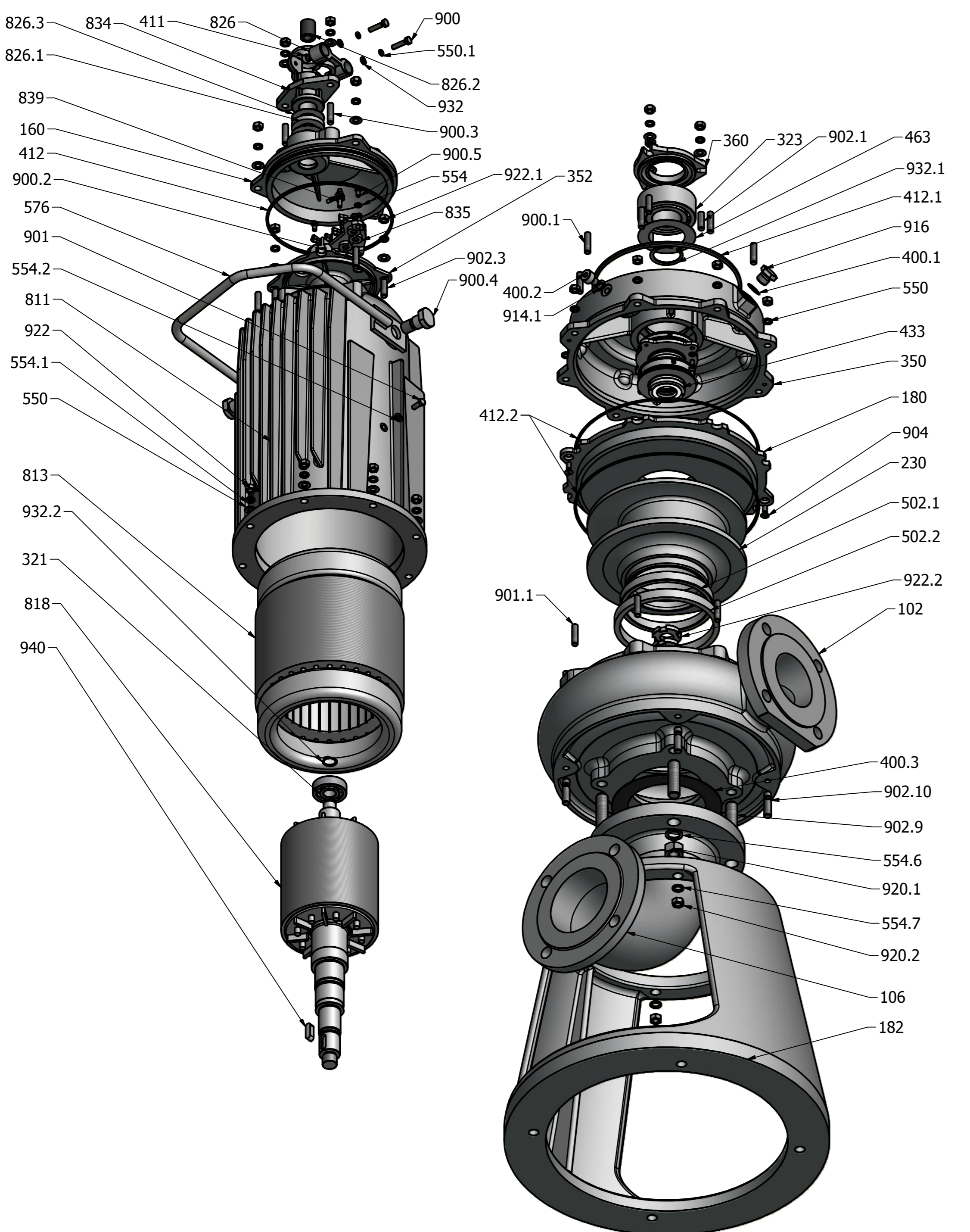

SUBMERSIBLE SLUDGE PUMP 80 - GFHU - SJ SPARE PARTS					
POSITIO N	NAME	NO. OF STOCK ITEM	NO. OF DRAWING	PC	
102	VOLUTE "SJ" "SJ"		20-SV-1494	1	
106	SUCTION ELBOW		20-SV-802404	1	
160	TERMINAL BOARD COVER		20-SV-805968	1	
180	OIL PAN BOTTOM		20-SV-804959	1	
181	MECHANICAL SEAL 2-SP-KK-28-80	UP 229	20-426 910 122 880 0	1	
182	LANTERN BRACKET		20-SV-802137	1	
230	IMPELLER		20-SV-7084	1	
321	BEARING UR 6303C3	20-324 163 030 086 0		1	
323	BEARING UR 3208C3	20-324 232 080 003 0		1	
350	LOWER BEARING HOUSING		20-SV-9748	1	
352	UPPER BEARING HOUSING		20-SV-805 959	1	
360	BEARING COVER		20-SV-533957	1	
400.1	WEAR RING 18X24	20-278 413 104 017 0		1	
400.2	WEAR RING 12X18X2	20-722 819 018 212 0		1	
400.3	RING 180X152X1,5		20-273 431 215 800 9	1	
411	RING SX9	20-722 811 005 009 0		2	
412.1	RING 190 X 5	20-273 111 014 704 0		1	
412.2	RING 240 X 3	20-273 111 014 774 0		2	
412	RING 160 X 3	20-273 111 014 634 0		1	
433	MECHANICAL SEAL 2Z-SP-KK-28-80	UP 229	20-426 910 122 880 0	1	
463	COVER SHEET		20-SV-537 410	1	
502.1	IMPELLER SEAL RING		20-SV-518845	1	
502.2	VOLUTE JOINT RING		20-SV-518844	1	
550	WASHER 8	CSN 02 1740.0	20-311 131 400 082 0	24	
550.1	WASHER 6	CSN 02 1740	20-311 131 400 061 9	2	
554	WASHER 5,3	CSN 02 1702.1	20-311 132 010 053 9	11	
554.1	WASHER 8,4	CSN 02 1740.1	20-311 132 010 084 0	25	
554.2	WASHER 6,4	CSN 02 1702.1	20-311 132 010 064 9	2	
554.6	WASHER 16	CSN 02 1740	20-311 131 400 162 9	4	
554.7	WASHER 10	CSN 02 1740	20-311 131 400 102 0	4	
576	HANDLE		20-4V-726 538	1	
811	STATOR BODY		20-SV-904045	1	
813	ELECTRIC MOTOR 4TMV 132S-2	EMBRNO	20-359 432 511 701 8	1	
818	ROTOR 4 TMV 132S-4		20-359 432 511 701 2	20-4V-735 972	1
824	CABLE HO7RN-F 6G1,5		20-341 999 999 004 0	1	
826	BUSHING CLIP		20-SV-527 389	1	
826.1	BUSHING RUBBER LINER	20-273 111 583 364 0		1	
826.2	BUSHING LINER	20-273 111 583 956 0		1	
826.3	WASHER		20-SV-584 306	2	
834	BUSHING		20-SV-720 539	1	
835	TERMINAL BOARD		20-SV-520 311	1	
839	EARTHING TERMINAL		20-SV-517 142	2	
900	BOLT M6 X 25	DIN 939/A2	20-311 112 090 625 0	2	
900.2	BOLT M8 X 20		20-991 511 167 250 0	3	
900.3	BOLT M8 X 30		20-991 511 087 130 0	2	
900.4	HANDLE SCREW		20-991 511 168 920 0	2	
900.5	BOLT M5X16	CSN 02 1226.0	20-311 112 260 516 0	3	
901	BOLT M6 X 12	CSN 02 1103.2	20-311 112 030 612 9	1	
901.1	BOLT M8 X 30		20-991 511 165 540 0	8	
902.1	BOLT M8 X 20	CSN 02 1176.2	20-311 112 780 820 9	3	
902.3	BOLT M8 X 25	CSN 02 1178.2	20-311 112 780 825 0	2	
902.9	BOLT M 16 X 50	CSN 02 1176	20-311 112 761 650 9	4	
902.10	BOLT M 10 X 35	CSN 02 1176	20-311 112 761 095 9	4	
904	BOLT M6 X 16	CSN 02 1151.9	20-311 112 590 616 0	2	
914.1	CHECK SCREW		20-SV-116529	1	
916	PLUG M16X1,5	DIN 910	20-991 503 161 500 0	1	
922	NUT M8	DIN 934/A2	20-311 122 010 800 9	4	
922.1	NUT M8	CSN 02 1401	20-311 122 010 800 9	5	
922.2	IMPELLER NUT		20-SV-109685	2	
932	WASHER 6,4	CSN 02 1702.1	20-311 132 010 064 9	2	
932.1	RETAINING RING 40		20-311 733 000 400 0	1	
932.2	RETAINING RING 17		20-311 733 000 170 0	1	

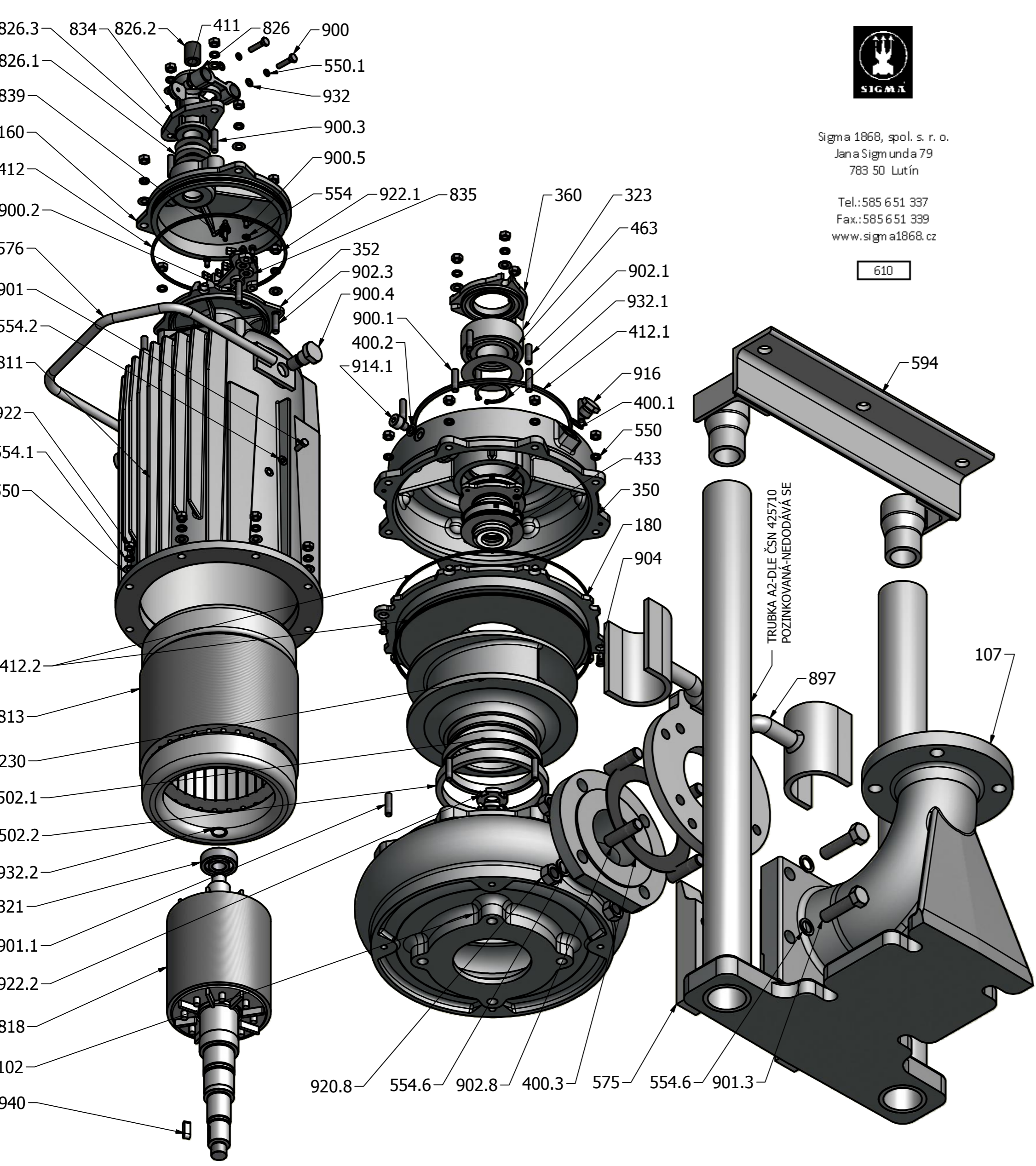

Submersible sludge pump 80 - GFHU - SZ - spare parts					
Positi on	Name	No. of stock item	No. of drawing	pc	
102	VOLUTE "SZ" "SZ"		20-SV-1494	1	
107	DISCHARGE ELBOW		20-SV-817 202	1	
160	TERMINAL BOARD COVER		20-SV-805968	1	
180	OIL PAN BOTTOM		20-SV-804959	1	
230	IMPELLER		20-SV-7084	1	
247	RING 80 X38 X 1,5	20-278 431 515 350 0		1	
321	BEARING UR 6303C3	20-324 163 030 086 0		1	
323	BEARING UR 3208C3	20-324 232 080 003 0		1	
350	LOWER BEARING HOUSING		20-SV-9748	1	
352	UPPER BEARING HOUSING		20-SV-805 959	1	
360	BEARING COVER		20-SV-533 957	1	
400.1	WEAR RING 18X24	20-278 413 104 017 0		1	
400.2	WEAR RING 12X18X2	20-722 819 018 212 0		1	
400.3	WEAR RING 80X38X1,5		20-278 431 515 350 0	1	
411	RING SX9	20-722 811 005 009 0		2	
412.1	RING 190 X 5	20-273 111 014 704 0		1	
412.2	RING 240 X 3	20-273 111 014 774 0		2	
412	RING 160 X 3	20-273 111 014 634 0		1	
433	MECHANICAL SEAL 2Z-SP-KK-28-80	UP 229	20-426 910 122 880 0	1	
463	COVER SHEET		20-SV-537 410	1	
502.1	IMPELLER SEAL RING		20-SV-518845	1	
502.2	VOLUTE JOINT RING		20-SV-518844	1	
550	WASHER 8	CSN 02 1740.0	20-311 131 400 082 0	24	
550.1	WASHER 6	CSN 02 1740	20-311 131 400 061 9	2	
554	WASHER 5,3	CSN 02 1702.1	20-311 132 010 053 9	11	
554.1	WASHER 8,4	CSN 02 1740.1	20-311 132 010 084 0	25	
554.2	WASHER 6,4	CSN 02 1702.1	20-311 132 010 064 9	2	
554.6	WASHER 16	CSN 02 1740	20-311 131 400 162 9	4	
554.7	WASHER 10	CSN 02 1740	20-311 131 400 102 0	4	
576	BACK PLATE		20-SV-538 440	2	
576	HANDLE		20-4V-726 538	1	
594	GUIDE PIPE CLAMP		20-SV-721 531	1	
811	STATOR BODY		20-SV-904 045	1	
813	ELECTRIC MOTOR 4TMV 132S-2	EMBRNO	20-359 432 511 701 8	1	
818	ROTOR 4 TMV 132S-4		20-359 432 511 701 2	20-4V-735 972	1
824	CABLE HO7RN-F 6G1,5		20-341 999 999 004 0	1	
826	BUSHING CLIP		20-SV-527 389	1	
826.1	BUSHING RUBBER LINER	20-273 111 583 364 0		1	
826.2	BUSHING LINER	20-273 111 583 956 0		1	
826.3	WASHER		20-SV-584 306	2	
834	BUSHING		20-SV-720 539	1	
835	TERMINAL BOARD		20-SV-520 311	1	
839	EARTH TERMINAL		20-SV-517 142	2	
897	FLANGE OF COVERING GEAR		20-SV-726 362	1	
900	BOLT M6 X 25	DIN 939/A2	20-311 112 090 625 0	2	
900.1	BOLT M8 X 25		20-991 511 165 5300	8	
900.2	BOLT M8 X 20		20-991 511 167 250 0	3	
900.3	BOLT M8 X 30		20-991 511 087 130 0	2	
900.4	HANDLE SCREW		20-991 511 168 920 0	2	
900.5	BOLT M5X16	CSN 02 1226.0	20-311 112 260 516 0	3	
901	BOLT M6 X 12	CSN 02 1103.2	20-311 112 030 612 9	1	
901.1	BOLT M8 X 30		20-991 511 165 540 0	8	
901.3	BOLT M16 X 60	CSN 02 1103.1	20-311 112 031 660 0	4	
902.1	BOLT M8 X 20	CSN 02 1176.2	20-311 112 780 820 9	3	
902.3	BOLT M8 X 25	CSN 02 1178.2	20-311 112 780 825 0	2	
902.8	BOLT M16 X 45	CSN 02 1174.1	20-311 112 741 645 0	4	
904	BOLT M6 X 16	CSN 02 1151.9	20-311 112 590 616 0	2	
914.1	CHECK SCREW		20-SV-116 529	1	
916	PLUG M16X1,5	DIN 910	20-991 503 161 500 0	1	
920.8	NUT M16		20-311 122 011 600 9	4	
922	NUT M8	DIN 934/A2	20-311 122 010 800 9	21	
922.1	NUT M8	DIN 934/A2	20-311 122 010 800 9	5	
922.2	IMPELLER NUT		20-SV-109 685	2	
932	WASHER 6,4	CSN 02 1702.1	20-311 132 010 064 9	2	
932.1	RETAINING RING 40		20-311		